



SPINNING ELEMENTS
FOR RIETER ROTORSPINNING

CATALOGUE

APRIL 2013

www.rimaxtechnology.com



The information in this leaflet are generally correct, however,
it is not possible to lay claim to liability or guarantee.
We reserve the right to make changes which serve the technical progress.



SPINNING ELEMENTS FOR RIETER ROTORSPINNING

MACHINES R1-RU04/14-RU11-R20

Dear Customer,

Rimax Technology is a small Italian company with the target to introduce in the market spare parts for textile machine in a good quality level at reasonable prices. With our partners with long experience and knowledge in the production of rotor and combing rollers for OE industry we are going to introduce our catalog of product for RIETER open end machines.

We are always working to enlarge our product range therefore in you have any inquiry of product which cannot be found in this catalog, please don't hesitate to contact us. Most probably we can submit you a proposal anyway.

Please take note that in addition to the spare parts for Rieter we are able to offer you component also for Schlafhost rotor spinning machine that you will find out in a separate catalogue.

■ OPENING ROLLER COMPLETE

TYPE	TOOTH SHAPE	FIBERS	SPEED RANGE rpm	CHARACTERISTICS
B-174 N B-174 DN		Cotton	6.000-8.000	Standard opening roller for cotton, intensive opening action, good fiber delivery, good wear resistance properties of the teeth
B-20 N B-20 DN		Rayon	6.000-8.000	Standard opening roller for cotton, intensive opening action, good fiber delivery, good wear resistance properties of the teeth
		Cotton Rayon	6.000-8.000	
S-21 N S-21 DN		Polyester/ Polyamide	6.000-8.500	Primarily for man-made fibers and their blends with cotton as well as linen. Also suitable for pure cotton with few trash and good average staple length
		Polyacrilic Rayon		
		Cotton blends	6.000-8.500	
		Pure cotton	6.000-8.500	

SPINNING ELEMENTS FOR RIETER ROTORSPINNING

Opening rollers Baering

For Rieter R1 - R20 and RU14 - RU11 - RU04

Code number OER54671



Opening rollers

For Rieter R1 - R20 and RU14 - RU11 - RU04

Type	Code number
B 174-N	OER174N
B 174-DN	OER174DN
B-20-N	OERB20N
B-20-DN	OERB20DN
B-21-N	OERB21N
B-21-DN	OERB21DN



Press-on type combing roller and slip on type combing ring

Combing roller press-on type

Type	Code number
B 174- N	OERP174N
B 174 -DN	OEP174DN
B-20-N	OERP20N
B-20-DN	OERP20DN
B-21-N	OERP21N
B-21-DN	OERP21DN



Combing roller Wire ring type

Type	Code number
B 174- N	OERS174N
B 174 -DN	OES174DN
B-20-N	OERS20N
B-20-DN	OERS20DN
B-21-N	OERS21N
B-21-DN	OERS21DN



SPINNING ELEMENTS FOR RIETER ROTORSPINNING

Twin discs

Wheel type	Code number
Wheel Dia. 63 mm	OETW63AA
Wheel Dia. 70 mm	OETW70AA



Twin discs bearings

Bearing type	Code number
RU11 wheel 63	OETB221
RU11 wheel 70	OETB251
RU14/RU04 (90.000 RPM)	OETB252
RU14A (100.000 RPM)	OETB262
R1 - R20	OETB256



Twin discs mounted with bearing

Type	Code number
RU11 wheel 63	OETBC25
RU11 wheel 70	OETBC47 distance 93
RU11 Wheel 70	OETBC32 distance 107
RU14/RU04 (90.000 RPM)	OETBC52
RU14A (100.000 RPM)	OETBC62
R1 - R 20	OETBR11



SPINNING ELEMENTS FOR RIETER ROTORSPINNING

Rotors for RU14A - 100.000 rpm



Diameter	Groove angle	Max rpm	Coating	Total length	Rieter no.	Code number	remarks
32 mm	S / 50°	115.000	diamond	147 mm	36	OER32S50	With ceramic insert
32 mm	S / 50°	115.000	Nickel	147 mm	35	OER32N50	
32 mm	N / 32°	115.000	diamond	147 mm	64	OER32S32	With ceramic insert
35 mm	S / 50°	100.000	diamond	147 mm	43	OER35S50	With ceramic insert
35 mm	S / 42°	100.000	Nickel	147 mm	34	OER35N42	
35 mm	N / 32°	100.000	diamond	147 mm	75	OER35N32	With ceramic insert
40 mm	S / 42°	85.000	Nickel	147 mm	30	OER40S42	
40 mm	69°	85.000	diamond	147 mm	80	OER40D69	
40 mm	N / 32°	85.000	diamond	147 mm	55	OER40N32	
48 mm	S/43,5°	70.000	diamond	147 mm	58	OER48S44	
48 mm	S / 40°	70.000	Nickel	147 mm	31	OER48S40	
48 mm	N / 88°	70.000	diamond	147 mm	78	OER48N88	
48 mm	O / 57°	70.000	Nickel	147 mm	7	OER48R57	
48 mm	R / 50°	70.000	diamond	147 mm	5	OER48R50	
56 mm	O / 57°	60.000	Nickel	147 mm	12	OER48O57	
56 mm	R / 50°	60.000	diamond	147 mm	10	OER48R50	
56 mm	R / 42°	60.000	Nickel	147 mm	33	OER48R42	

Further rotors on request

Groove: S = Standard groove N = Narrow groove O = Open groove R = groove for regenerated fibers

SPINNING ELEMENTS FOR RIETER ROTORSPINNING

Rotors for RU14 (90.000 rpm) and RU04

Diameter	Groove angle	Max rpm	Coating	Total lenght	Rieter no.	Code number	remarks
35 mm	S / 50°	100.000	diamond	150,7 mm	43	OET35S50	With ceramic insert
35 mm	S / 42°	100.000	Nickel	150,7 mm	34	OET35N42	
35 mm	N / 32°	100.000	diamond	150,7 mm	75	OET35N32	With ceramic insert
40 mm	S / 42°	85.000	Nickel	150,7 mm	30	OET40S42	
40 mm	69°	85.000	diamond	150,7 mm	80	OET40D69	
48 mm	S/43,5°	70.000	diamond	150,7 mm	58	OET48S44	
48 mm	S / 40°	70.000	Nickel	150,7 mm	31	OET48S40	
48 mm	N / 88°	70.000	diamond	150,7 mm	78	OET48N88	
48 mm	O / 57°	70.000	Nickel	150,7 mm	7	OET48R57	
48 mm	R / 50°	70.000	diamond	150,7 mm	5	OET48R50	
56 mm	O / 57°	60.000	Nickel	150,7 mm	12	OET48O57	
56 mm	R / 50°	60.000	diamond	150,7 mm	10	OET48R50	
56 mm	R / 42°	60.000	Nickel	150,7 mm	33	OET48R42	
48 mm	R / 50°	70.000	diamond	147 mm	5	OER48R50	
56 mm	O / 57°	60.000	Nickel	147 mm	12	OER48O57	
56 mm	R / 50°	60.000	diamond	147 mm	10	OER48R50	
56 mm	R / 42°	60.000	Nickel	147 mm	33	OER48R42	

Further rotors on request

Groove: S = Standard groove N = Narrow groove O = Open groove R = groove for regenerated fibers

Rotors for RU11

Diameter	Groove angle	Max rpm	Coating	Total lenght	Rieter no.	Code number	remarks
40 mm	S / 42°	85.000	Nickel	171,4 mm	30	OEZ40S42	
40 mm	69°	85.000	diamond	171,4 mm	80	OEZ40D69	
40 mm	N / 32°	85.000	diamond	171,4 mm	55	OEZ40N32	
48 mm	S/43,5°	70.000	diamond	171,4 mm	58	OEZ48S44	
48 mm	S / 40°	70.000	Nickel	171,4 mm	31	OEZ48S40	
48 mm	N / 88°	70.000	diamond	171,4 mm	78	OEZ48N88	
48 mm	O / 57°	70.000	Nickel	171,4 mm	7	OEZ48R57	
48 mm	R / 50°	70.000	diamond	171,4 mm	5	OEZ48R50	
56 mm	O / 57°	60.000	Nickel	171,4 mm	12	OEZ48O57	
56 mm	R / 50°	60.000	diamond	171,4 mm	10	OEZ48R50	
56 mm	R / 42°	60.000	Nickel	171,4 mm	33	OEZ48R42	
56 mm	R / 50°	60.000	diamond	150,7 mm	10	OET48R50	
56 mm	R / 42°	60.000	Nickel	150,7 mm	33	OET48R42	
48 mm	R / 50°	70.000	diamond	147 mm	5	OER48R50	
56 mm	O / 57°	60.000	Nickel	147 mm	12	OER48O57	
56 mm	R / 50°	60.000	diamond	147 mm	10	OER48R50	
56 mm	R / 42°	60.000	Nickel	147 mm	33	OER48R42	

Further rotors on request

Groove: S = Standard groove N = Narrow groove O = Open groove R = groove for regenerated fibers

SPINNING ELEMENTS FOR RIETER ROTORSPINNING

Rotors for R1 and R20



Diameter	Groove angle	Max rpm	Coating	Total lenght	Rieter no.	Code number	remarks
28 mm	S	140.000	Diamond	117 mm	-/191	0EW28S00	
30 mm	S	135.000	Boronized	117 mm	39/139	0EW30SOB	
30 mm	S	135.000	Diamond	117 mm	38/138	0EW30SOD	
32 mm	S	115.000	Borinized	117 mm	-/135	0EW32SOB	
32 mm	S	115.000	Nickel	117 mm	35/-	0EW32SON	With ceramic insert
32 mm	S	115.000	Diamond	117 mm	36/136	0EW32SOD	
32 mm	N	115.000	diamond	117 mm	64/164	0EW32NOD	With ceramic insert
35 mm	S	90.000	Boronized	117 mm	34/134	0EW35SOB	With ceramic insert
35 mm	S	90.000	Diamond	117 mm	3-/145	0EW35SOD	
35 mm	N	90.000	Diamond	117 mm	75/175	0EW35NOD	With ceramic insert
40 mm	S	85.000	Nickel	117 mm	30/130	0EW40SON	
40 mm	S	85.000	Boronized	117 mm	-/186	0EW40SOB	
40 mm	S	85.000	Diamond	117 mm	-/189	0EW40SOD	
40 mm	N	85.000	diamond	117 mm	55/155	0EW40NOD	
40 mm	O	85.000	diamond	117 mm	80/180	0EW4000D	
48 mm	S	70.000	Nickel	117 mm	31/131	0EW48SON	
48 mm	S	70.000	Nickel	117 mm	78/178	0EW48S1N	
48 mm	R	70.000	Diamond	117 mm	05/-	0EW48ROD	
56 mm	R	60.000	Nickel	117 mm	33/133	0EW56RON	
56 mm	R	60.000	Diamond	117 mm	10/-	0EW56ROD	

Further rotors on request

GROOVE: S = Standard groove N = Narrow groove O = Open groove R = groove for regenerated fibers

SPINNING ELEMENTS FOR RIETER ROTORSPINNING

Draw-off nozzles

The nozzles are crucial for yarn characteristic. The design of the navel has substantial influence also in the spinning stability.

Smooth navel is offering good yarn values and low Hairiness

Notches navels is giving better spinning stability in relation to the smooth one. More notches increase the hairiness.

Spiral is offering very good yarn properties with low hairiness. Lower spinning stability in confrontation to the Notches one.

Whirl insert can be offered in addition for increasing of the hairiness and the yarn becomes bulky.



SMOOTH

4 NOTCHES

6 NOTCHES

8 NOTCHES

SPIRAL



RU11, RU04/14 - R1

Type

KN
KN4
KN6
KN8
KS

Code number

OEM12KN0
OEM12KN4
OEM12KN6
OEM12KN8
OEM12KS0

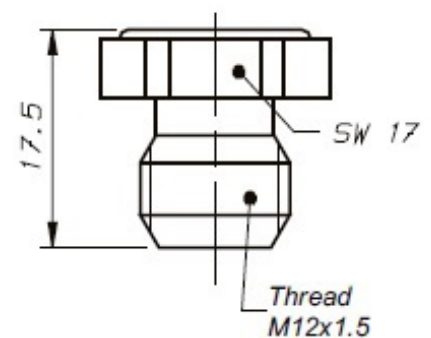

Combing roller Wire ring type

RU11, RU04/14, R1 R20 (magnetic)

Type

KN
KN4
KN6
KN8
KS

Code number

OED60KN0
OED60KN4
OED60KN6
OED60KN8
OED60KS0

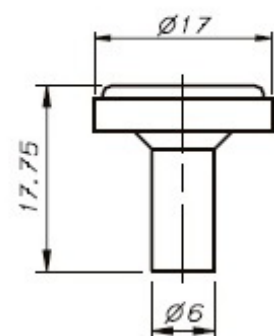

Other type available on request.



RiMax Technology Srl

Piazza Garibaldi 7 - 21013 GALLARATE (VA) SEDE OPERATIVA: Via Fratelli di Dio 1 - 21052 BUSTO ARSIZIO (VA)
Tel +39 0331 1547396 · Fax +39 0331 1812358
e-mail: info@rimaxtechnology.com

www.rimaxtechnology.com